

Product End-of-Life Instructions

Rack Enclosures and Accessories

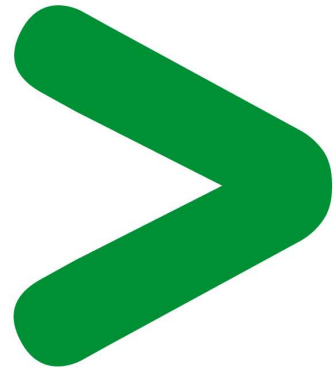

Product End-of-Life Instructions – EoLI

Product overview

Product Range: Rack Rail Enclosures and Accessories

Marketing Model/Name: AR3100 NetShelter SX 42U

Size: H x L x D in mm = 1991 x 600 x 1070

Weight in g = 144,550g (for the AR3100 NetShelter SX 42U)

The mass of the product range as complete units is from 91,001 g and 500,321 g including packaging. Individual rack parts sold separately range from 14 g and 25,885 g including packaging.

The product range includes models AR1XX, AR2XXX, AR3XXX, AR4XX, AR7XXX and AR8XXX where XXX is any number.

Purpose

The product family must be disposed according to the legislation of the country. This document is intended for use by end of life recyclers or treatment facilities. It provides the basic information to assure an appropriate end of life treatment for the components and materials of the product.

Operations recommended for the end of life treatment

There are several steps to process the products at the end of life so as to recover components, materials or energy :

Reuse → Separation for special treatment → Other dismantling → Shredding

CAUTION:

The components of the products that optimize the recycling performances are listed, identified and located hereunder.

Disassembly Instructions:

1. Remove electronics and other equipment from the rack per the manufacturers' instructions.
2. Disassemble remaining rack components and place into the appropriate recycling waste stream.

Product End-of-Life Instructions – EoLI

The components of the products that optimize the recycling performances are listed, identified and located hereunder.

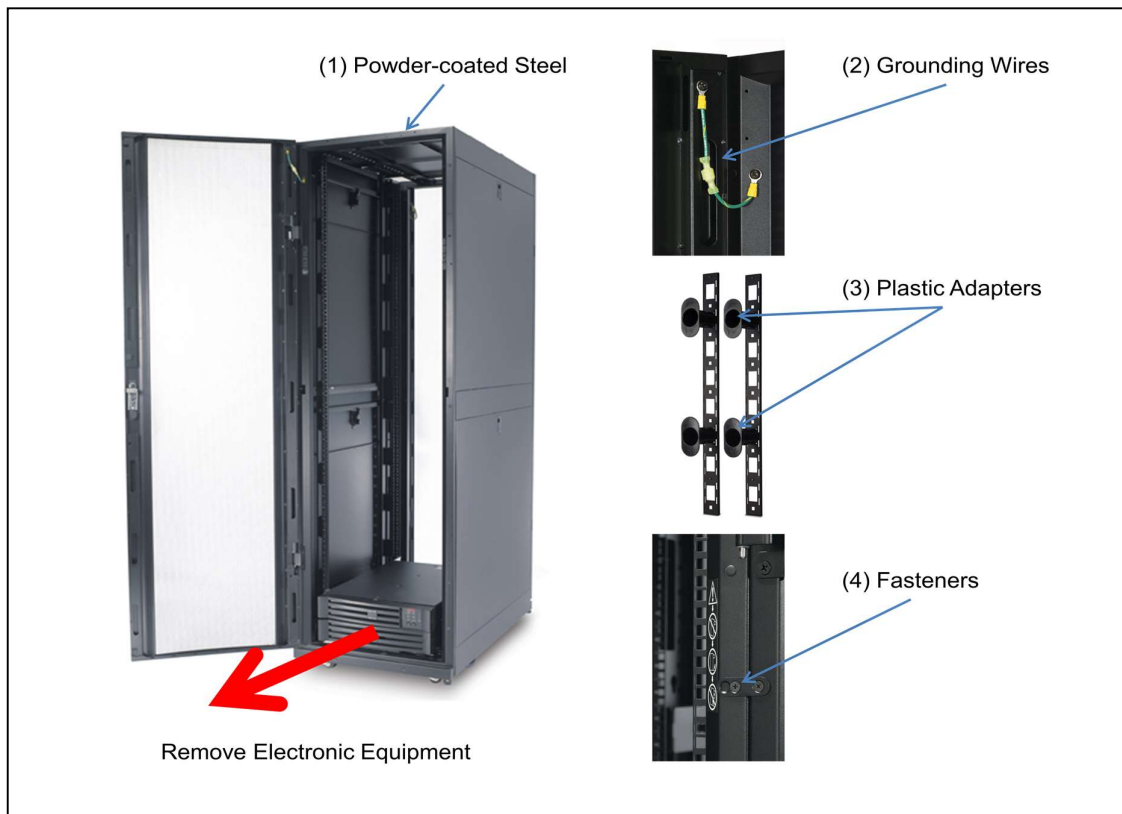

Recommendation	Number on drawing	Components	Weight (in g)	Comment
Special treatment	(1)	Plated or powder-coated metal rails	500 – 2970 each	Cold Rolled Steel
Special treatment	(2)	Cable	50 – 150 each	Brominated flame retarded (BFR) nylon moulded connectors.

EoLI achieved with Schneider-Electric TT03 V5 procedure

Schneider Electric Industries SAS

35, rue Joseph Monier
 CS 30323
 F- 92506 Rueil Malmaison Cedex
 RCS Nanterre 954 503 439
 Capital social 896 313 776 €

www.schneider-electric.com