

Quick Installation Guide

TL-WA854RE

- Option ONE:** Quick Setup using the WPS Button
- Option TWO:** Setup using your Web Browser

LED Legend

RE
On: The extender is connected to the router.
Blinking: WPS connection is in process.
Off: The extender is not connected to the router.

Wireless
On/Off: The extender's wireless function is on or off.

Power
On/Off: The extender is powered on or off.

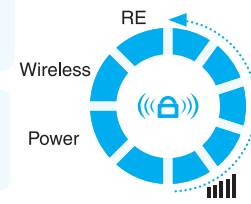

(Signal Strength)
Indicates the Wi-Fi connection between the extender and the router. More lit LEDs indicate a better signal strength.

7106505382 REV2.00

Option ONE

Quick Setup using the WPS Button

Your router should support WPS. Otherwise, please use Option TWO.

1 Power on

Plug in next to your router.

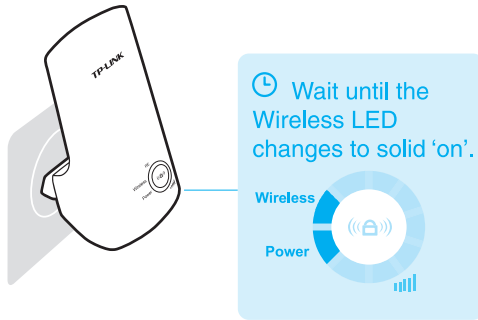

2 Connect

- Press the WPS button on your router.
- Press the button.
- The RE LED should go from blinking to solid 'on'.

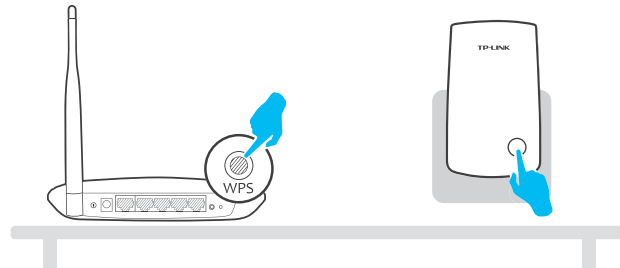

The RE LED should go from blinking to solid 'on'.



If the RE LED does not go from blinking to solid 'on', please use **Option TWO**.

3 Relocate

- Plug in the extender halfway between your router and the Wi-Fi dead zone.
- Wait until the (Signal Strength) LEDs are lit. Make sure the extender is in a location with **3 or more LEDs lit**. If not, **relocate it closer to the router** to achieve a good (or better) signal quality.

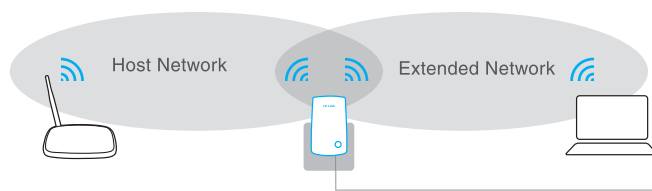

far away

Choose a location away from Bluetooth devices and other household electronics, such as cordless phone, microwave, and baby monitor, etc., to minimize signal interference.

Enjoy!

The extended network shares the same SSID (network name) and password as your host network.

Frequently Asked Questions (FAQ)

Q1. What should I do if my router doesn't have a WPS button?

A: Please use **Option TWO** to set up the extender.

Q2. Why the RE LED doesn't light up after I completed Option TWO?

A1: You may have typed in the router's wireless password incorrectly, please log in and verify the wireless password.

A2: The extender may be out-of-range, please move it closer to the router.

Q3. Why can't I see the login page after entering <http://tplinkrepeater.net> in the browser?

A1: Make sure your computer is connected to extender's network.

A2: Make sure your computer is set to obtain an IP address automatically.

Q4. How do I reset the extender?

A: While the extender is powered on, use a pin to press the RESET button until all the LEDs turn on momentarily, then release the button.

Option TWO

Setup using your Web Browser

1

Power on

Plug in next to your router.

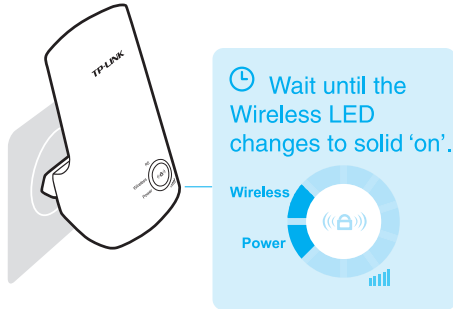

2

Login

- 1 Disconnect your Ethernet (wired) connection to your computer. Click the Wi-Fi icon on the taskbar and connect to the extender's network (e.g. TP-LINK_Extender_XXXXXX).

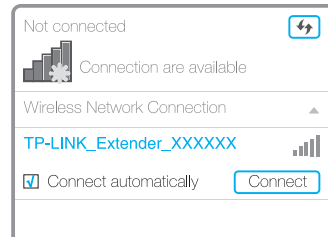

- 2 Launch a web browser and type <http://tplinkrepeater.net> into the URL field and use **admin** (all lowercase) for both Username and Password to log in.

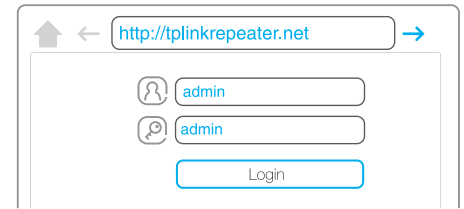

If the login window does not pop up, please refer to the FAQ > Q3.

3

Configure

- 1 Create a new username and password to log in the web management page, then click **Confirm**.
- 2 Select your region, then click **Next**.
- 3 Select your router's **2.4GHz host network** and enter the password, then click **Next**.

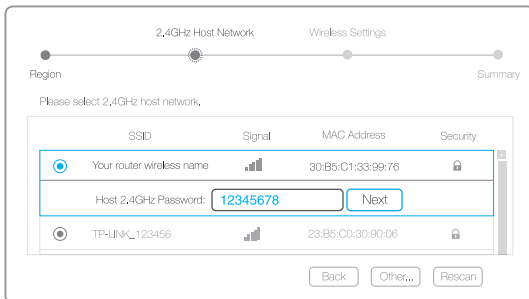

- 4 Either copy the host's SSID or customize it for 2.4GHz extended network, then click **Next**.

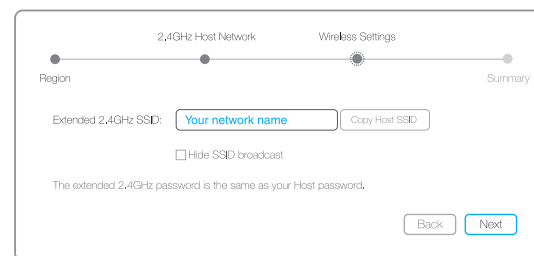

- 5 Verify your wireless settings and click **Finish**. The RE LED should turn on and stay solid.

4

Relocate

- 1 Plug in the extender halfway between your router and the Wi-Fi dead zone.
- 2 Wait until the (Signal Strength) LEDs are lit. Make sure the extender is in a location with **3 or more LEDs lit**. If not, **relocate it closer to the router** to achieve a good (or better) signal quality.

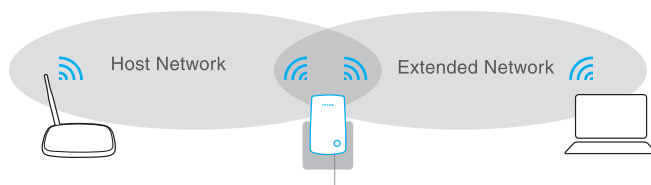

Choose a location away from Bluetooth devices and other household electronics, such as cordless phone, microwave, and baby monitor, etc., to minimize signal interference.

Enjoy!

The extended network shares the same Wi-Fi password as your host network, but may have different wireless network name if you customize the name during the configuration.